

620 TERMINAL WAY • P. O. BOX 938 • COSTA MESA, CALIFORNIA 92627 • (714) 642-1163

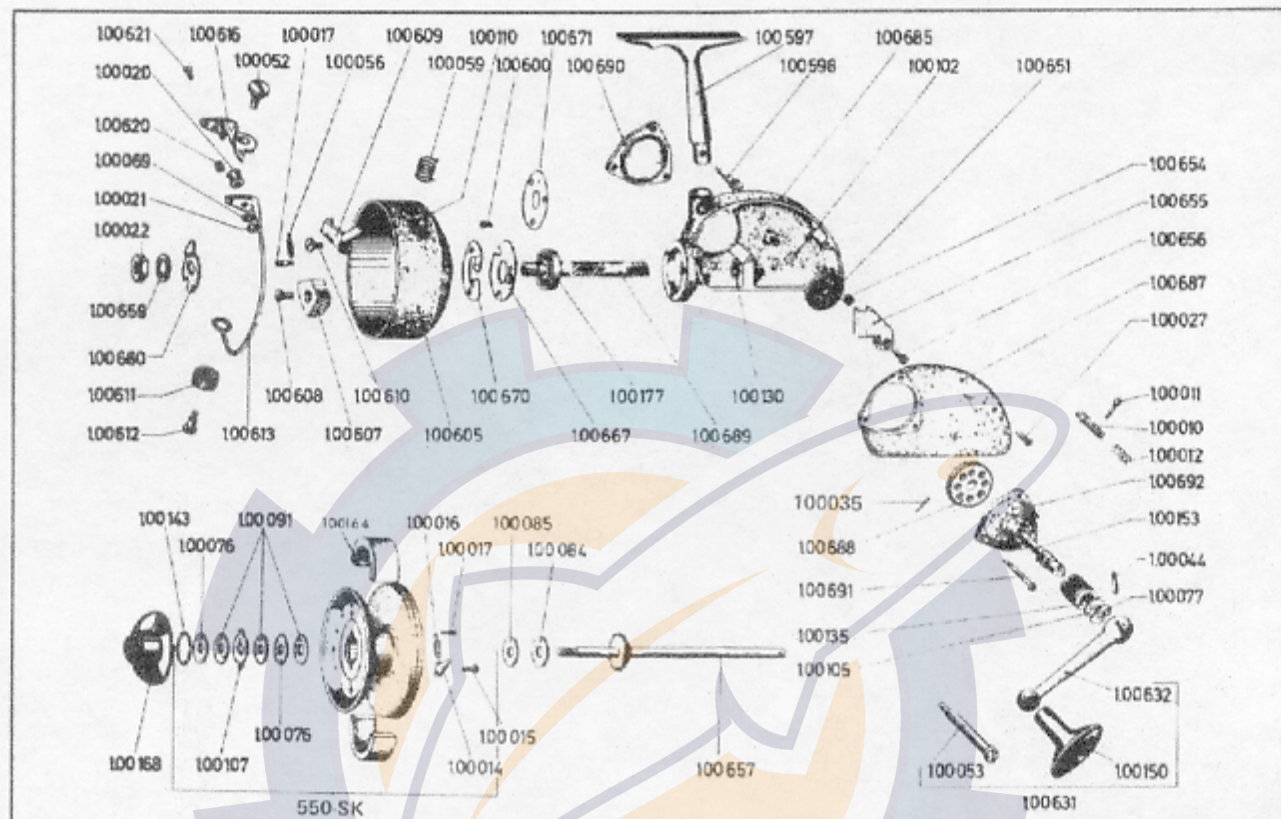

**IMPORTANT: AN "N" SERIES QUICK SPOOL WILL NOT FIT THIS REEL.**

| PART NO. | DESCRIPTION               | LIST PRICE | PART NO. | DESCRIPTION                            | LIST PRICE |
|----------|---------------------------|------------|----------|--|------------|
| 100-010  | Anti-reverse pin          |            | 100-177  | Ball bearing                           |            |
| 100-011  | Ball lever                |            | 100-597  | Reel stand                             |            |
| 100-012  | Spring                    |            | 100-598  | Cone screw                             |            |
| 100-014  | Click tongue              |            | 100-600  | Screw for switch ring                  |            |
| 100-015  | Pin                       |            | 100-605  | Rotating Head W/607 & 608              |            |
| 100-016  | Spring                    |            | 100-607  | Counter-weight                         |            |
| 100-017  | Pin                       |            | 100-606  | Screw for counter-weight               |            |
| 100-020  | Line guide                |            | 100-609  | Trip lever                             |            |
| 100-021  | Hexagon nut               |            | 100-610  | Lug screw                              |            |
| 100-022  | Hexagon nut               |            | 100-611  | Cap for pick up arm                    |            |
| 100-027  | Screw for case cover      |            | 100-612  | Bearing screw                          |            |
| 100-038  | Pin for drive gear        |            | 100-613  | Bail                                   |            |
| 100-044  | Pin for crank arm         |            | 100-616  | Angle lever                            |            |
| 100-052  | Bearing screw             |            | 100-620  | Spacing bushing                        |            |
| 100-053  | Grip screw                |            | 100-621  | Screw for angle lever                  |            |
| 100-056  | Spring                    |            | 100-631  | Crank arm, complete                    |            |
| 100-059  | Ball spring               |            | 100-632  | Crank arm                              |            |
| 100-069  | Lock washer               |            | 100-651  | Worm wheel with pin                    |            |
| 100-077  | Washer                    |            | 100-654  | Roller                                 |            |
| 100-076  | Tongue washer             |            | 100-655  | Slide                                  |            |
| 100-084  | Washer (metal)            |            | 100-656  | Screw for slide                        |            |
| 100-085  | Washer (resitex)          |            | 100-657  | Axle, complete                         |            |
| 100-091  | Washer (resitex)          |            | 100-659  | Spring washer                          |            |
| 100-102  | Washer                    |            | 100-660  | Drive plate                            |            |
| 100-105  | Washer slotted            |            | 100-667  | Switch ring                            |            |
| 100-107  | Driving plate             |            | 100-670  | Braking ring                           |            |
| 100-110  | Rubber buffer with spring |            | 100-671  | Gasket                                 |            |
| 100-130  | Bushing                   |            | 100-685  | Housing with bushing                   |            |
| 100-135  | Crank nut                 |            | 100-687  | Housing cover                          |            |
| 100-143  | Snap ring                 |            | 100-688  | Drive gear                             |            |
| 100-150  | Handle grip               |            | 100-689  | Drive shaft                            |            |
| 100-153  | Drive axle                |            | 100-690  | Plate cover                            |            |
| 100-164  | Cork ring (2 halves)      |            | 100-691  | Screw for bearing cover                |            |
| 100-168  | Drag nut                  |            | 100-692  | Bearing cover with bushing and oiler   |            |
|          |                           |            | 550 SK   | Spool, complete                        |            |
|          |                           |            | ...      | To convert to manual bail use P/N B460 |            |